

FT3HV

(Former FOX923CEH)

3.2mm x 2.5mm

HCMOS VCTCXO



Features

- Digital Temperature Compensation

STANDARD SPECIFICATIONS	
PARAMETERS	MAX (Unless otherwise noted)
Frequency Range (MHz)	8.0 ~ 40.000
Temperature Range	
Operating (T _{OPR})	(See table below)
Storage (T _{STG})	-40°C ~ +90°C
Supply Voltage (V _{DD})	+3.3 V _{DC} ±5%
Input Current (I _{DD})	6.0 mA
Initial Frequency Tolerance @ 25°C (after reflow) (T3HV: V _c = 1.66V) ¹	±2.0 PPM
Frequency Stability	
Over Temperature Range	See table below
Over Supply Voltage Change (3.3V±5%)	±0.3 PPM
Over Load Change (15pF ±5%)	±0.3 PPM
Rise Time (10% ~90% V _{DD})	5nS
Fall Time (90% ~10% V _{DD})	5nS
Symmetry (50% V _{DD})	40% ~ 60%
Output Voltage (V _{OL})	10% V _{DD}
(V _{OH})	90%V _{DD} Min
Output Load (C _L)	15pF
Pullability (T3HV: V _c = 1.65V±1.0V) ¹	±3 ~ ±15 PPM
Aging per year	±1.0 PPM
Startup Time (T _s)	3.0 mS
Phase Noise @ 1kHz offset	-130 dBc/Hz Typical
Reflow Soldering Temp	260°C / 10 Seconds x 2
Moisture Sensitivity Level (MSL)	1
Termination Finish	Au over Ni
Lead-Free	Yes
RoHS/REACH Compliant	Yes

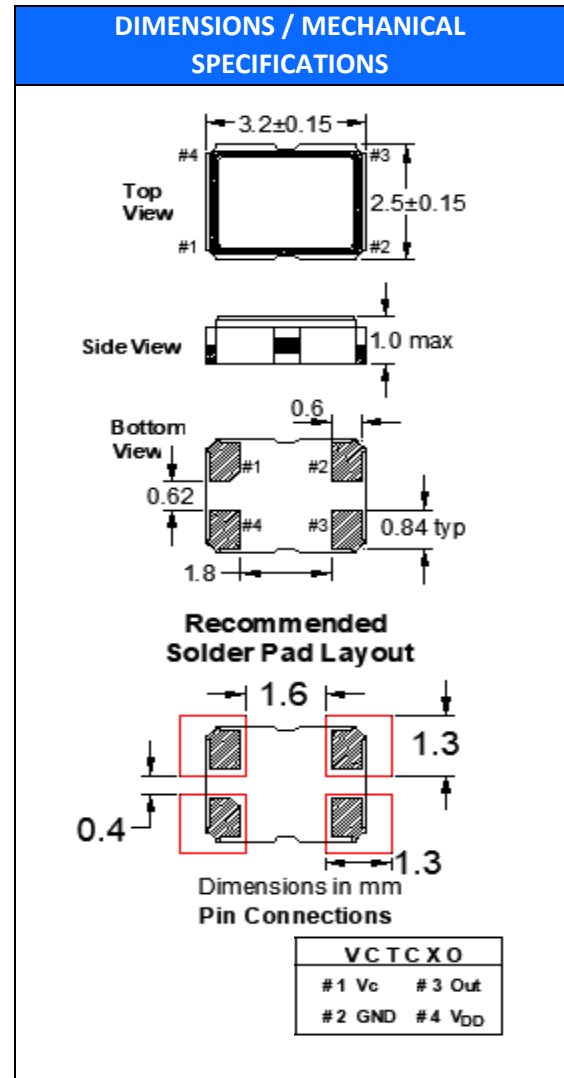

Available Options by Stability & Operating Temp					
Operating Temperature	±1 PPM	±1.5 PPM	±2 PPM	±2.5 PPM	±15 PPM
-30 ~+85°C	O	O	O	O	NA
-40 ~+85°C	Δ	O	O	O	NA
-40 ~+105°C	X	X	X	X	O

Key: O=Available, X=Not Available, NA=Not Applicable, Δ = Consult Fox Engineering

¹For proper operation, a control voltage (V_c) must be applied to pin 1 of VCTCXO's. All specifications subject to change without notice.

FT3HV

(Former FOX923CEH)

3.2mm x 2.5mm

HCMOS VCTCXO



TAPE SPECIFICATIONS (mm)							REEL SPECIFICATIONS (mm)						
A	B	C	D	E	F	REEL QTY	G	H	I	J	K	L	M
ø1.5	4.0	4.0	3.5	8.0	1.4	-T3 = 3,000 default -T2 = 2,000 -T1 = 1,000	2.0	ø13	ø21	ø60	ø180	9.0	1.5

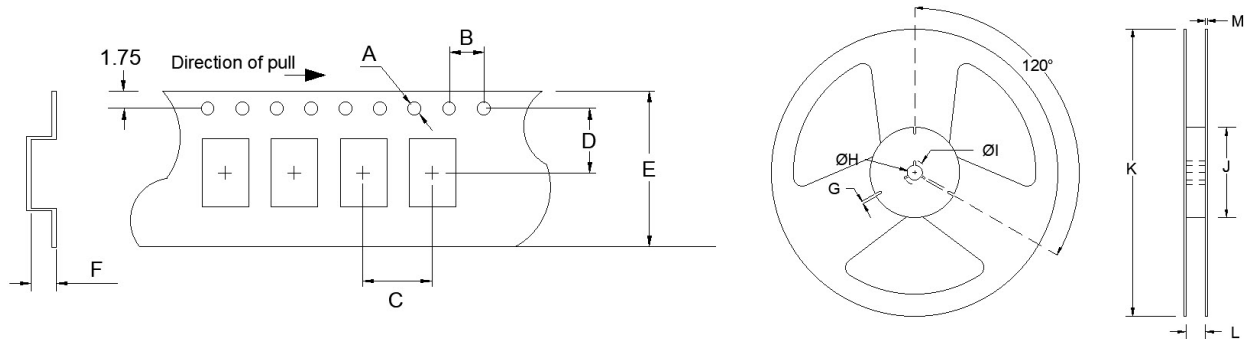

Available Options & Part Identification for VCTCXO Model T3HV¹

Sample PN: **FT3HVBPK25.0-T3**

F	T3HN	B	P	K	25.0	-T3
Fox	Model Number T3HV = VCTCXO	Tolerance B = +3.3V±5%	Stability T = ±1.0 PPM S = ±1.5 PPM R = ±2.0 PPM P = ±2.5 PPM F = ±15 PPM	Operating Temperature K = -30 to +85°C M = -40 to +85°C P = -40 to +105°C	Frequency (MHz)	Values Added Options Blank = Bulk T1 = 1,000 pcs T2 = 2,000 pcs T3 = 3,000 pcs

¹ Not all frequencies in the frequency range, or every combination of stability, temp range, and voltage available. See stabilities/operating temp table.

Reliability Test Conditions

Please contact Abracon Quality Assurance department